

# Hudson

## BEARINGS

### BT 1-1/2

Flange-Mounted Ball Transfers



BT 1-1/2



NBT 1-1/2

Additional ball materials available

| Part Number           | Housing Mat.    | Ball Material   | Load Cap. |
|-----------------------|-----------------|-----------------|-----------|
| <b>BT 1-1/2 CS</b>    | Carbon Steel    | Carbon Steel    | 250 lbs.  |
| <b>NBT 1-1/2 CS</b>   | Carbon Steel    | Nylon           | 250 lbs.  |
| <b>BT 1-1/2 CS/SS</b> | Carbon Steel    | Stainless Steel | 250 lbs.  |
| <b>BT 1-1/2 SS</b>    | Stainless Steel | Stainless Steel | 250 lbs.  |

#### FOUR-HOLE, FLANGE MOUNTED, ALL-STEEL

- 1-1/2" Main ball rotates on 3/16" support balls.
- Ball support cup is hardened and plated.
- Protective cover assures low torque and longevity.
- Available in stainless steel for additional corrosion resistance.

NOTE: Neoprene cushion available to permit vertical deflection and assist with uniform load distribution. (Part number CBT 1-1/2)

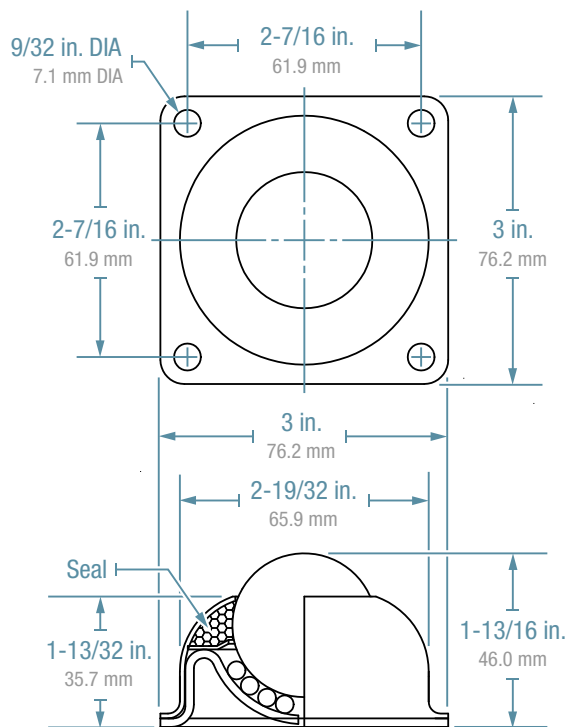

All product designs subject to change, please verify accuracy of dimensions.